

DO NOT SCALE FROM THIS DRAWING. USE FIGURED DIMENSIONS IN ALL CASES.  
 VERIFY DIMENSIONS ON SITE AND REPORT ANY DISCREPANCIES TO THE DESIGNERS IMMEDIATELY.  
 THIS DRAWING TO BE READ IN CONJUNCTION WITH THE DESIGNERS SPECIFICATION.  
 © THIS DRAWING IS COPYRIGHT AND MAY ONLY BE REPRODUCED WITH THE DESIGNERS PERMISSION.

Please consider the environment before printing this sheet

LEGEND:

This drawing forms part of the soft landscape package of drawings, and should be read in conjunction with the full set of drawings, which consists of the following:

- CAH-HLM-00-00-DR-L-4500 SOFT LANDSCAPE PLAN SHEET 1
- CAH-HLM-00-00-DR-L-4501 SOFT LANDSCAPE PLAN SHEET 2
- CAH-HLM-00-00-DR-L-45002 SOFT LANDSCAPE PLANTING SCHEDULE
- CAH-HLM-00-00-DR-L-4503 SOFT LANDSCAPE DETAILS - TREE PIT DETAILS
- CAR-JBG-ZZ-XX-SP-L-0060 LANDSCAPE SPECIFICATION

Area outside of the boundary walls in abeyance - clarification required on extent of soft landscape works in this area.

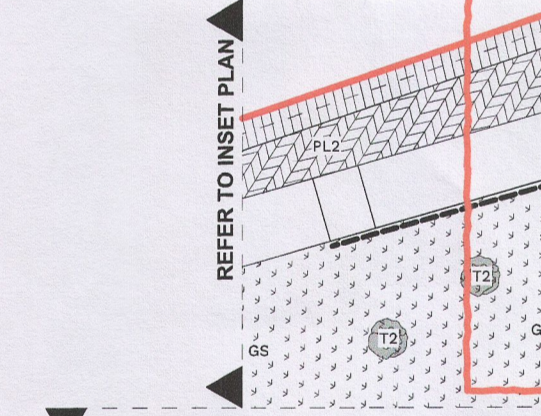
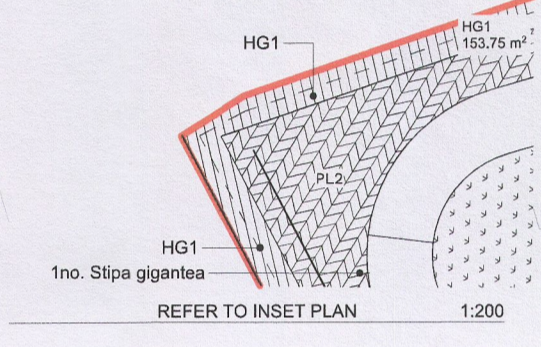
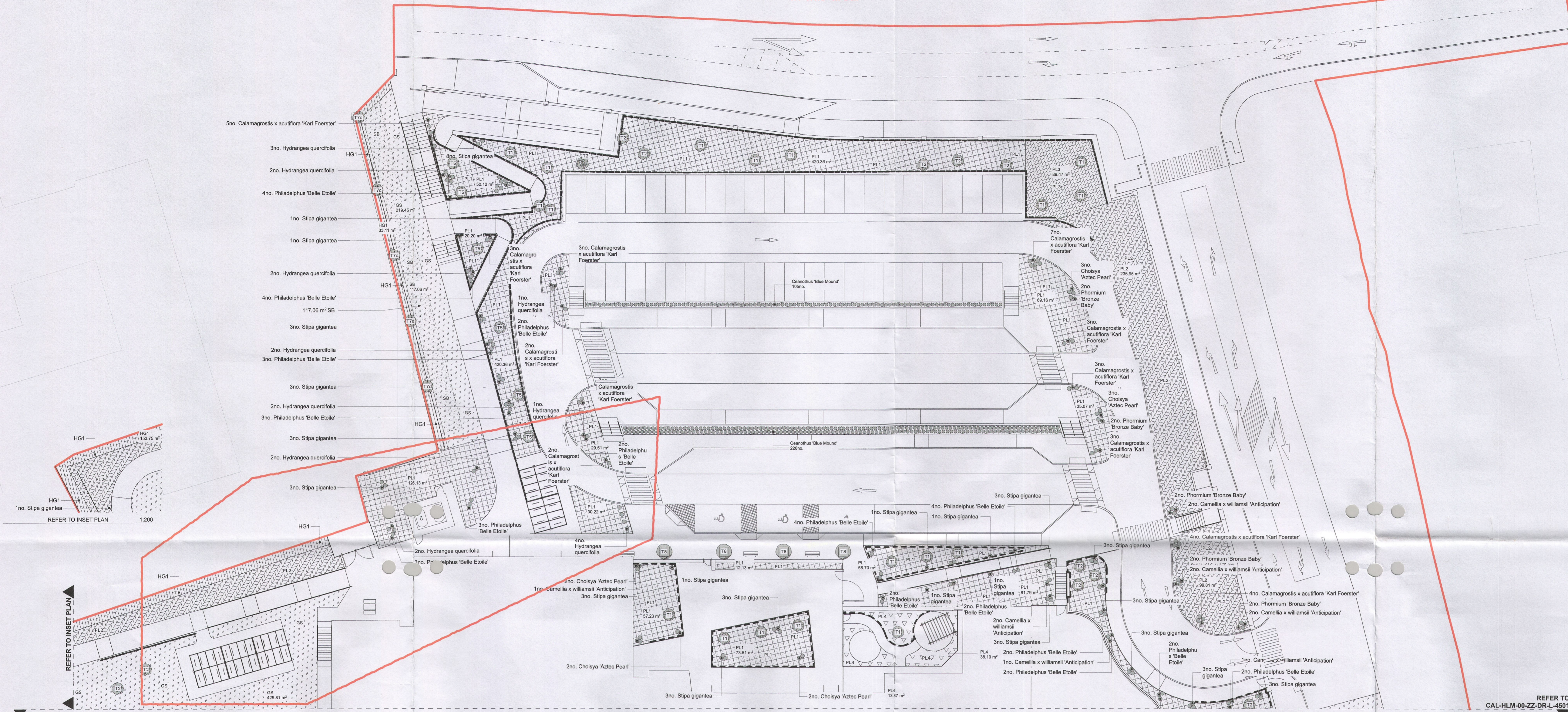

REFER TO CAL-HLM-00-ZZ-DR-L-4501

- SOFT LANDSCAPE PLAN KEY**  
 For exact plant numbers, species and specifications, refer to drawing CAH-HLM-00-00-DR-L-4502 SOFT LANDSCAPE PLANTING SCHEDULE
- Site boundary** (Red line)
  - Mixed native hedgerow (HG1)**: To be planted with 450mm depth topsoil and 75mm depth bark mulch.
  - Internal hedge (HG2)**: To be planted with 450mm depth topsoil and 75mm depth bark mulch.
  - Planting Mix 1 (PL1)**: Low maintenance, ornamental planting mix to school's ground. To be planted with 450mm depth topsoil and 75mm depth bark mulch.
  - Planting Mix 2 (PL2)**: Low maintenance, ornamental planting mix to school's ground. To be planted with 450mm depth topsoil and 75mm depth bark mulch.
  - Planting Mix 3 (PL3)**: Low maintenance, low level planting mix. To be planted with 450mm depth topsoil and 75mm depth bark mulch.
  - Planting Mix 4 (PL4)**: Low maintenance, sensory planting mix to playground. To be planted with 450mm depth topsoil and 75mm depth bark mulch.
  - Proposed Grass Seed (GS)**: To be planted with 150mm depth topsoil.
  - Spring Bub Planting in Amenity Grass (SB)**

- Root Protection Barrier**: Green Blue Urban's 'ReRoot' 1000mm or similar. To extend 300mm below depth of services or hard landscape it is installed to protect. Indicative locations shown on drawing with further coordination required. NOTE: ROOT BARRIER LOCATION TO BE COORDINATED WITH UNDERGROUND SERVICES. INFORMATION ON M&E NOT AVAILABLE AT THE TIME OF ISSUE.
- Proposed Tree (in hard landscape)**: Refer to CAH-HLM-00-00-DR-L-4503 Detail 01.
- Proposed Tree (in soft landscape)**: Refer to CAH-HLM-00-00-DR-L-4503 Detail 02.
- Proposed Specimen Plants**: In soft landscape.
- Green retaining feature**: Indicative location, retaining feature height and length to be co-ordinated with structural engineers. Planting type to match Planting Mix 2 (PL2).

**Weed control**  
 The weed control fabric shall be 105gsm and shall suppress weeds whilst allowing water, air and nutrients to pass through. Cut with a scissors or knife. All sharp objects should be removed from the surface soil prior to laying the weed suppressing geotextile. Overlap adjacent rolls by at least 10cm. Membrane to be pegged to ground using proprietary plastic pegs. When planting into the geotextile membrane an 'X' shaped notch should be cut into the membrane for each individual plant, to allow for excavation. Planting should resume as per species specification. Excavated material should not be stored on geotextile and the membrane area should be thoroughly swept of any residual material prior to application of finished aggregate or mulch. Membrane to be applied to all planting and gravel areas.

**Notes**  
 Ecological enhancements as required by project ecologist.

REV	DATE	BY	DESCRIPTION
001	26.01.2022	HV	ISSUE FOR TENDER
002	26.01.2022	LJ	ISSUE FOR TENDER
003	26.01.2022	CM	ISSUE FOR TENDER
004	26.01.2022	CM	ISSUE FOR TENDER

Department of Education & Skills (DoES)  
 School Frameworks - Lot 1 & 2

CLIENT: An Roinn Oideachais agus Scileanna  
 Department of Education and Skills

JOINT VENTURE: **bam** | **GLASGIVEN CONTRACTS LTD**

PROJECT: 2D - Carrs Hill Primary School

TITLE: **SOFT LANDSCAPE PLAN SHEET 1**

DATE: 26.01.2022	DISCIPLINE: L	SCALE @ AD: 1:200
DRAWN BY: HV	CHECKED: CM	APPROVED: CM
SUITABILITY DESCRIPTION: FOR REVIEW & COMMENT	STATUS CODE: S3	
DRAWING NUMBER: CAH-HLM-00-00-DR-L-4500	REVISION: P03	

1:200