



Comhairle Cathrach Chorcaí

Cork City Council

Halla na Cathrach, Corcaigh - City Hall, Cork - T12 T997

Mary O'Sullivan,
6 Lachteen Place,
Grenagh,
Co. Cork T23 FK03

14/09/2022

**RE: Section 5 Declaration R734/22 Morning Star National School,
Connolly Road, Ballyphehane, Cork**

A Chara,

With reference to your request for a Section 5 Declaration at the above-named property, received on 25th August 2022, I wish to advise as follows:

It is considered that the operation of a preschool use comes under the definition of a school in that a preschool provides "early childhood education". Having regard to the established and existing use of this building as a school, the preschool use would not constitute a material change of use and would therefore be **EXEMPTED DEVELOPMENT**.

Under Section 5(3)(a) of the Planning and Development Act, 2000, you may, on payment of the appropriate fee, refer this declaration for review by An Bord Pleanála within 4 weeks of the date it is issued, 14th September 2022.

Is mise le meas,

Kate Magner
Development Management Section
Community, Culture and Placemaking Directorate
Cork City Council



We are Cork.

Allstars Preschool
Ballyphehane,
Cork T12R657

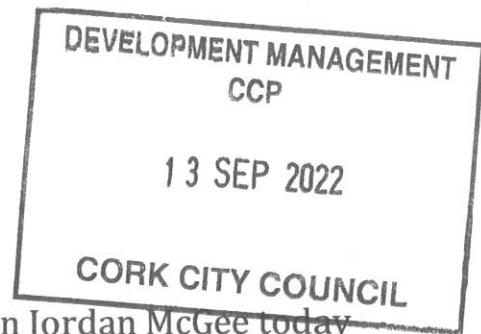

To whom it concerns,

Re : Section 5 Declaration.

Following a conversation I had with Gwen Jordan McGee today Monday 12th September I wish to confirm that I intend to operate a preschool under the existing educational regulations.

It will be a sessional preschool running for just 3 hours a day five days a week.

Hope this confirmation will help the Section 5 Declaration submitted.

Kind regards

Mary O'Sullivan.

A handwritten signature in blue ink, appearing to read "MO'Sullivan".

12/09/2022

**COMHAIRLE CATHRACH CHORCAÍ
CORK CITY COUNCIL**

Community, Culture & Placemaking Directorate,
Cork City Council, City Hall, Anglesea Street, Cork.

R-Phost/E-Mail planning@corkcity.ie

Fón/Tel: 021-4924709

Líonra/Web: www.corkcity.ie

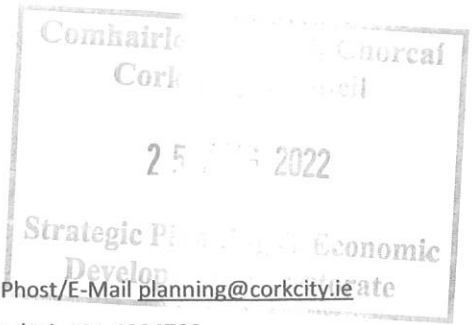

SECTION 5 DECLARATION APPLICATION FORM
under Section 5 of the Planning & Development Acts 2000 (as amended)

1. POSTAL ADDRESS OF LAND OR STRUCTURE FOR WHICH DECLARATION IS SOUGHT

Connolly Rd, Ballyphehane, Cork T12 R657

2. QUESTION/ DECLARATION DETAILS

PLEASE STATE THE SPECIFIC QUESTION FOR WHICH A DECLARATION IS SOUGHT:

Sample Question: Is the construction of a shed at No 1 Wall St, Cork development and if so, is it exempted development?

Note: only works listed and described under this section will be assessed under the section 5 declaration.

My name is MARY O'Sullivan.
The room in question is within Morning Star primary school. There has been a preschool here for many years. I'm intending to run a preschool here. It's for 3 hours a day, 5 days a week. It is for 3-6 yr olds. Capacity for 22 children.
We will operate from 9am - 12pm

ADDITIONAL DETAILS REGARDING QUESTION/ WORKS/ DEVELOPMENT:

(Use additional sheets if required).

There has been no alterations made to this room. It is self contained
The room in question is last one in corridor marked with a green dot (on map) nearest to exit door. Sketch enclosed, also one of room in detail. The name of the preschool is Allstars Preschool Ltd

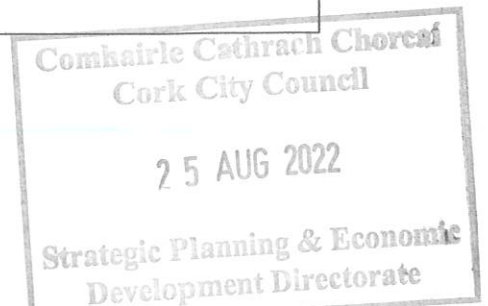

3. Are you aware of any enforcement proceedings connected to this site?
 If so please supply details: No

4. Is this a Protected Structure or within the curtilage of a Protected Structure? No

If yes, has a Declaration under Section 57 of the Planning & Development Act 2000 been requested or issued for the property by the Planning Authority?

5. Was there previous relevant planning application/s on this site? No
 If so please supply details:

Tusla accepted a sworn Affidavit previously as that Preschool was there for more than 5 years.

6. APPLICATION DETAILS

Answer the following if applicable. Note: Floor areas are measured from the inside of the external walls and should be indicated in square meters (sq. M)

(a) Floor area of existing/proposed structure/s	<u>70.4 sq m</u>
(b) If a domestic extension, have any previous extensions/structures been erected at this location after 1 st October, 1964, (including those for which planning permission has been obtained)?	Yes <input type="checkbox"/> No <input checked="" type="checkbox"/> If yes, please provide floor areas. (sq m)
(c) If concerning a change of use of land and / or building(s), please state the following:	
Existing/ previous use (please circle)	Proposed/existing use (please circle)
<u>No change of use</u>	

7. LEGAL INTEREST

Please tick appropriate box to show applicant's legal interest in the land or structure	A. Owner <input type="checkbox"/>	B. Other <input checked="" type="checkbox"/>
Where legal interest is 'Other', please state your interest in the land/structure in question	<u>I have permission from the school to operate a preschool,</u>	
If you are not the legal owner, please state the name and address of the owner if available	<u>Diocese of Cork and Ross Redemption Rd, Cork</u>	

8. I / ~~We~~ confirm that the information contained in the application is true and accurate:

Signature: MOSCH
 Date: 24/08/2022

CONTACT DETAILS

9. Applicant:

Name(s)	Mary O'Sullivan
Address	b. Lachteen Place Grenagh Co Cork T23 FK03

10. Person/Agent acting on behalf of the Applicant (if any):

Name(s):	
Address:	
Telephone:	
E-mail address:	
Should all correspondence be sent to the above address? (Please note that if the answer is 'No', all correspondence will be sent to the Applicant's address)	Yes <input checked="" type="checkbox"/> No <input type="checkbox"/>

11. ADDITIONAL CONTACT DETAILS

The provision of additional contact information such as email addresses or phone numbers is voluntary and will only be used by the Planning Authority to contact you should it be deemed necessary for the purposes of administering the application.

Tel. No. 

Mobile No. 

Email Address: 

For Office Use Only: File Ref. No. _____

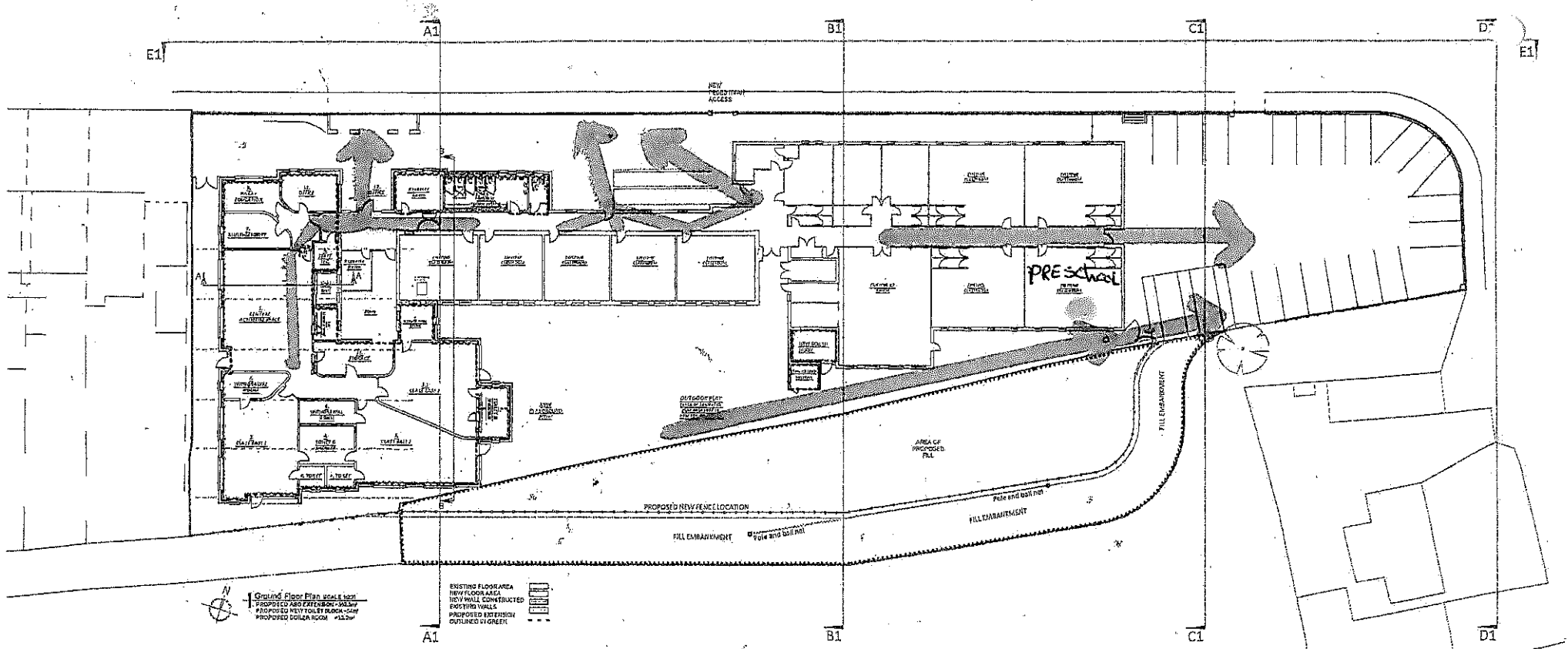

MORNING STAR NATIONAL SCHOOL
Scoil Réalt na Maidine
 BALLYTHEHANE - CORK



Evacuation Procedure

↑
← OUTDOOR Area →

Classroom
→

